

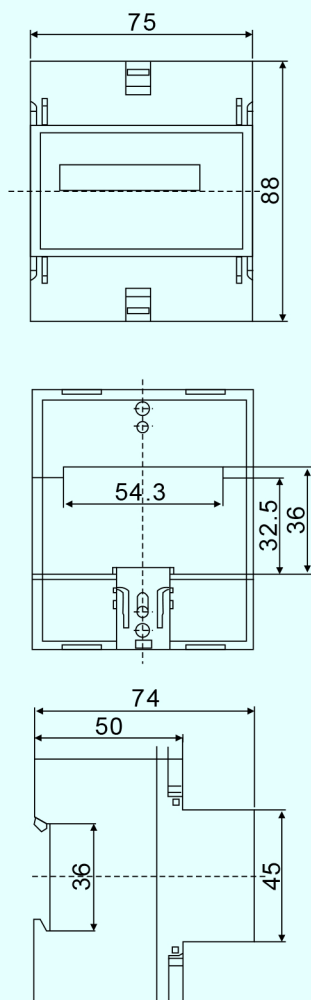

Overall and installation dimensions

Weight: about 0.4kg



Product Overview

The single-phase active energy meter using the latest release of the ASIC ADE7755 energy meter design and manufacture of high precision, good linearity, wide operating voltage range and high reliability, low power, wide loads etc. Applies to rated voltage 220V. Rated frequency 50Hz AC single-phase active energy measurement.

The products comply with IEC 62053-21, IEC 62052-11 and effective energy (1 and 2) the exchange of static watt-hours sheet test.

Features

- active energy metering, long-term work is not to adjust;
- using ADE7755 special measuring chip;
- using the latest embedded digital multiplier foreign power application specific integrated circuit, greatly increased the instruments dynamic range, the actual overload up to 10 times more;
- at 5% $I_b \sim I_{max}$ good within the error of linear;
- external components, low power consumption, meter, simple structure;
- meter all the elements are optional long-life, high reliability electronic components, and thus has a long life and high reliability characteristics;

The main technical parameters

Rated current	2.5 (10)A、 5 (20)A、 5 (30)A、 10 (40)A、 15 (60)A、 20 (80)A
Rated voltage	220V、 230V
Rated frequency	50Hz、 60Hz
The accuracy class	class 1.0、 class 2.0